

## Standard Barrel - Two Hole Narrow Tongue with Inspection Window

### Type BLU-D-NT

- Manufactured from high conductivity seamless copper tubing
- Tin-plated to inhibit corrosion
- Beveled entry for easy cable insertion
- Inspection window to ensure full cable insertion
- Two hole mounting pad assures maximum secureness
- **Narrow tongue design for limited space applications**
- Color coded barrels are marked with die index numbers
- Connectors are suitable for voltages up to 35 KV
- 45° and 90° angles are UL listed and CSA certified
- **Connectors are UL listed and CSA certified with Penn-Union, Burndy, T&B, Huskie, Greenlee and Versa-Crimp® style tooling**

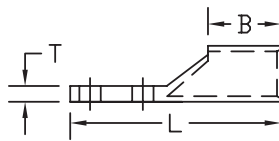
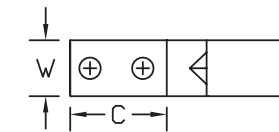

#### BLU-D-NT

See table for dimensions and installation tooling information

## BLU-D-NT DIMENSIONS & INSTALLATION TOOLING INFORMATION

CATALOG NUMBER	COPPER CONDUCTOR SIZE	STUD HOLE SIZE	FIGURE DIMENSIONS (IN.)						INSTALLATION TOOLING				WIRE STRIP LENGTH
			STUD HOLE SPACING	TONGUE WIDTH "W"	TONGUE LENGTH "C"	TONGUE THICKNESS "T"	BARREL LENGTH "B"	OVERALL LENGTH "L"	COLOR CODE	PENN-UNION DIELESS MECHANICAL TOOLS	BURNDY DIE INDEX NO.	PENN-UNION DIE CATALOG NO.	
BLU-4D-2TC10-NT	4 AWG	#10	.63	.40	1.22	.11	.81	2.33	Gray	TDM-250 or TDM-500	8	T-8	15/16"
BLU-4D-2TC10E1-NT		#10	1.00	.40	1.61	.11	.81	2.68					
BLU-4D-2TC14-NT		1/4"	.63	.40	1.22	.11	.81	2.33					
BLU-4D-2TC14E2-NT		1/4"	.75	.40	1.36	.11	.81	2.43					
BLU-4D-2TC14E1-NT		1/4"	1.00	.40	1.61	.11	.81	2.68					
BLU-2D-2TC14-NT	2 AWG	1/4"	.63	.50	1.22	.13	.88	2.32	Brown	TDM-250 or TDM-500	10	T-10	1"
BLU-2D-2TC14E2-NT		1/4"	.75	.50	1.36	.13	.88	2.49					
BLU-2D-2TC14E1-NT		1/4"	1.00	.50	1.61	.13	.88	2.74					
BLU-1D-2TC14-NT	1 AWG	1/4"	.63	.50	1.22	.13	.94	2.41	Green	TDM-250 or TDM-500	11	T-11	1-1/16"
BLU-1D-2TC14E2-NT		1/4"	.75	.50	1.36	.13	.94	2.55					
BLU-1D-2TC516-NT		5/16"	1.00	.50	1.72	.13	.94	2.88					
BLU-1/0D-2TC14-NT	1/0 AWG	1/4"	.63	.62	1.22	.13	.88	2.44	Pink	TDM-250 or TDM-500	12	T-12	1"
BLU-1/0D-2TC14E1-NT		1/4"	1.00	.62	1.61	.13	.88	2.80					
BLU-1/0D-2TC516E6-NT		5/16"	.88	.62	1.62	.13	.88	2.81					
BLU-1/0D-2TC516-NT		5/16"	1.00	.62	1.72	.13	.88	2.94					
BLU-2/0D-2TC14-NT	2/0 AWG	1/4"	.63	.62	1.22	.16	.94	2.50	Black	TDM-250 or TDM-500	13	T-13	1-1/16"
BLU-2/0D-2TC14E1-NT		1/4"	1.00	.62	1.61	.16	.94	2.89					
BLU-2/0D-2TC516-NT		5/16"	1.00	.62	1.83	.16	.94	3.08					
BLU-2/0D-2TC38-NT		3/8"	1.00	.62	1.83	.16	.94	3.08					
BLU-3/0D-2TC14-NT	3/0 AWG	1/4"	.63	.64	1.22	.18	1.00	2.60	Orange	TDM-250 or TDM-500	14	T-14	1-1/8"
BLU-3/0D-2TC38-NT		3/8"	1.00	.64	1.83	.18	1.00	3.24					
BLU-3/0D-2TC516-NT		5/16"	1.00	.64	1.72	.18	1.00	3.13					
BLU-4/0D-2TC14-NT	4/0 AWG	1/4"	.63	.71	1.22	.20	1.00	2.66	Purple	TDM-250 or TDM-500	15	T-15	1-1/8"
BLU-4/0D-2TC38-NT		3/8"	1.00	.71	1.83	.20	1.00	3.30					
BLU-4/0D-2TC516-NT		5/16"	1.00	.71	1.72	.20	1.00	3.16					
BLU-025D-2TC14-NT	250 kcmil	1/4"	.63	.77	1.22	.23	1.06	2.78	Yellow	TDM-250 or TDM-500	16	T-16	1-3/16"
BLU-025D-2TC38-NT		3/8"	1.00	.77	1.83	.23	1.06	3.43					
BLU-025D-2TC38E16-NT	350 kcmil	3/8"	1.75	.77	2.81	.23	1.06	4.37	Red	TDM-500	18	T-18	1-1/4"
BLU-035D-2TC38-NT		3/8"	1.00	.88	1.83	.25	1.13	3.61					
BLU-035D-2TC38E16-NT	500 kcmil	3/8"	1.75	.88	2.81	.25	1.13	4.57	Brown	TDM-500	20	T-20	1-1/2"
BLU-050D-2TC38-NT		3/8"	1.00	1.06	1.83	.26	1.38	3.87					
BLU-050D-2TC38E16-NT		3/8"	1.75	1.06	2.81	.26	1.38	4.94					
BLU-050D-2TC12E1-NT	600 kcmil	1/2"	1.00	1.06	2.09	.26	1.38	4.22	Green	TDM-500	22	T-22	1-1/2"
BLU-050D-NT		1/2"	1.75	1.06	2.95	.26	1.38	4.99					
BLU-060D-NT	750 kcmil	1/2"	1.75	1.19	2.88	.39	1.38	5.09	Black	TDM-500	24	T-24	1-3/4"
BLU-075D-2TC38-NT	3/8"	1.00	1.30	1.83	.32	1.63	4.30						
BLU-075D-2TC38E16-NT	3/8"	1.75	1.30	2.81	.32	1.63	5.38						
BLU-075D-2TC12E1-NT	1/2"	1.00	1.30	2.09	.32	1.63	4.66						
BLU-075D-NT	1000 kcmil	1/2"	1.75	1.30	2.85	.32	1.63	5.32	White	TDM-500	27	T-27P	2"
BLU-100D-2TC38-NT		3/8"	1.00	1.50	1.83	.38	1.88	4.61					
BLU-100D-2TC38E16-NT		3/8"	1.75	1.50	2.81	.38	1.88	5.81					
BLU-100D-NT		1/2"	1.75	1.50	2.85	.38	1.88	5.65					

• For 45° or 90° BENT TONGUES add suffix "-45" for 45 deg. or "-90" for 90 deg. to the catalog number

- Connectors from 8 AWG - 2000 kcmil are UL listed per UL486A-B and CSA certified per C22.2 No.65 for POWER applications
- Connectors from 8 AWG - 500 kcmil are UL listed for grounding, bonding and direct burial applications per UL467
- Connectors from 8 AWG - 250 kcmil are CSA certified for grounding, bonding and direct burial applications per C22.2 No.41